



i tape



E-COMMERCE

i tape



E-COMMERCE

At IPG®, we understand the needs of today's dynamic and changing fulfillment environment. Whether you're a 3PL, an internet retailer, a mail order/catalog provider or managing your own fulfillment operation, we have the products you need to keep your supply chain humming. IPG's broad portfolio of packaging and machinery products can increase the effectiveness of your automation needs and our printed tapes can help you create customized packaging solutions while ensuring the security of each package. We are proud to be your end-of-the-line packaging experts.

BRANDS YOU TRUST

With over 100 years of history behind IPG's Central® brand tape (founded in 1917) and Better Packages® brand tape dispensers (also founded in 1917), IPG knows the business of packaging! In addition to tape, we are pleased to offer mailers, bubble and paper cushioning, insulated packaging, and our new Curby® sustainable packaging products, expanding our portfolio for the e-commerce market. Some of our new sustainable products include:

- Curby Mailer™
- Curby Fragile Wrap™
- Curby Mini-Taper™



TABLE OF CONTENTS

4 CURBY



5 COLD CHAIN



5 FRAGILE WRAP

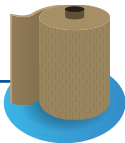

6 VOID FILL

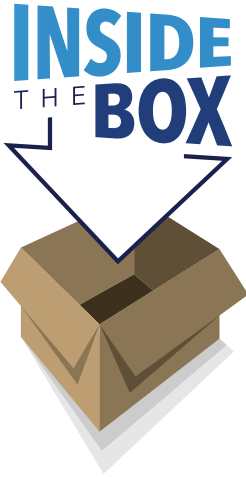

8 CASE SEALING

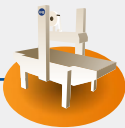

12 PACKAGING TAPES



20 FILMS



23 MAILERS



24 BRANDING & SECURITY

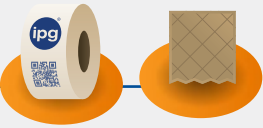



WATER-ACTIVATED TAPE



PAPERSPACE SYSTEMS



CURBY MAILER™



CURBY FRAGILE WRAP™



CHILL-R® PAPER INSERT



CURBY MINI TAPER™



Meet Curby®, IPG's line of sustainable packaging products. As e-commerce shipping volumes rapidly increase and consumers become ever more aware of their environmental impact, IPG's curbside-friendly products are the logical next step in packaging. Curby products promote a *circular economy* and help answer these e-commerce growth challenges.

Curby products offer peace of mind that your package is **renewably sourced, securely shipped, and curbside recyclable**. Join Curby and do your part to support a healthy planet.



COLD CHAIN

IPG introduces Chill-R™, a set of insulated packaging that uses a pre-consumer paper insulation material. This material is specifically designed to provide a temperature-controlled environment while shipping meal kit home deliveries and sensitive medical products.



CHILL-R™ 2-PIECE INSERT

- Curbside recyclable and repulpable paper insulation contained in high grade Kraft paper
- Soft interior increases cushioning for delicate items during transportation
- Stays flat in transit and storage, taking up less space in the warehouse

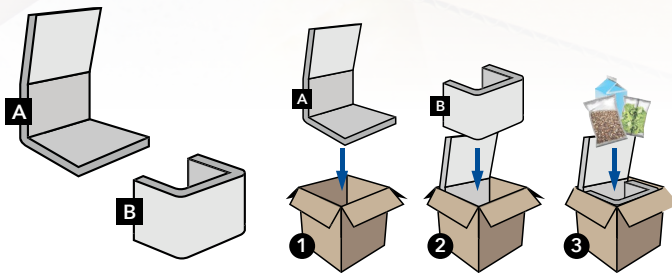

FRAGILE WRAP

IPG's Curby Fragile Wrap™ is a renewable paper solution for fragile packaging that has proven to reduce damage during shipping and delivery. Curby Fragile Wrap is **Cradle to Cradle Certified® Silver*** and curbside recyclable. It is an innovative, patent-pending honeycomb cushioning material that exceeds protection rates of traditional fragile wraps. This paper cushioning is used to wrap and protect glassware, cosmetics, electronics and anything fragile. Increases overall operational and pack efficiency without the need for automation and saves space in your warehouse and pack stations.

CURBY FRAGILE WRAP™

PAPER PART NUMBER	MATERIAL	PAPER WIDTH	CUSHIONED AREA	ROLL WEIGHT
H-1002	50# Kraft Paper	12" expanded; 15.25" not expanded	1400 ft expanded; 840 ft not expanded	18 lbs
H-1002W	50# Bleached White Paper	12" expanded; 15.25" not expanded	1400 ft expanded; 840 ft not expanded	18 lbs

MACHINE PART NUMBER (METAL UNIT)	DIMENSIONS	UNIT WEIGHT
MPS-1100	Unit- 13.25" x 17.5" x 8.5" Box - 13.75" x 18.0" x 9.0"	4 lbs

Additional non-stock integration options available. Please consult your sales representative for more information.



*For more information visit www.itape.com/c2c

VOID FILL

Inflatable Systems

IPG's growing line of protective packaging includes a variety of air pillow systems that can satisfy our customer's various volume and productivity needs. Air pillows are engineered to be lightweight, durable, and reusable for any future packaging. With diverse air pillow machines to easily operate, air pillows can be quickly produced in even the most demanding environments.

AIRSPACE™ A3 PRO

DIMENSIONS L x W x H	WEIGHT	AIR PILLOW SPEED	BUBBLE-ON-DEMAND SPEED
15.7" x 7.3" x 10.6"	20 lbs	Up to 59 ft/min	33ft/min (16" BOD) 20ft/min (32" BOD)

- Air and temperature adjustments are preset for different kind of pillows
- Two operational languages
- Easy to integrate for special operation needs
- Fast startup and accredited by high recognitive TUV



AIRSPACE™ A3^{PRO}

AIRSPACE SYSTEMS

PRODUCT	DIMENSIONS	WEIGHT	AIR PILLOW FILM SPEED	DESCRIPTION
AirSpace G6	16" x 12" x 14.125"	22 lbs	40 to 100ft/min	Versatile machine yields bubble or pillow without machine modification; bilingual touch screen interface; easy roll changes from bubble to air pillow film
AirSpace G4	15" x 12"	26 lbs	Up to 75 ft/min	Runs multiple film, sizes and thickness; easy to load film; easy to use operator controls; does not require tools to change the main wear parts

SELECT AIR PILLOW OPTIONS

PRODUCT	MIL THICKNESS	SIZE	ROLL LENGTH
G4080575	0.75 mil	8" x 5"	4750'
G4080675	0.75 mil	8" x 6"	4750'
G400875	0.75 mil	8" x 8"	4750'
G4100675	0.75 mil	10" x 6"	3750'
G4101075	0.75 mil	10" x 10"	3750'
G4160308	0.8 mil	16" x 3"	2500'
G4080501	1 mil	8" x 5"	3500'
G4080801	1 mil	8" x 8"	3500'
G4080518	1.8 mil	8" x 5"	1925'
G4160318	1.8 mil	16" x 6"	1000'

BUBBLE-ON-DEMAND OPTIONS

PRODUCT	MIL THICKNESS	SIZE	INFLATED SHEET SIZE	ROLL LENGTH
GB121212515	1.57 mil	15" x 12"	12" x 12"	1500'
GB120612515	1.57 mil	15" X 6"	12" x 6"	1500'

FILM FEATURES & BENEFITS

Pillow-on-demand (POD) film

- Durable 1 mil air pillows for the toughest of void fill and blocking applications with maximum protection
- Our printed air pillows prominently display the How2Recycle® logo in blue ink on the air pillows themselves



Bubble-on-demand (BOD) film

- Film inflates to full 12" x 12" packaging pads
- AirSpace Bubble-On-Demand runs at 40 ft per minute for on-demand packaging

Paper Systems

IPG's protective packaging line now includes paper filling as a sustainable option for void fill and cushioning. PaperSpace™ offers substantial benefits over traditional wrapping material, including bubble, bubble-on-demand, and foam. It provides significant return on investment for end users, including damage reduction, pack time efficiencies, and less packaging material to process and order.



POWERED BY **NUEVOPAK**

X-FILL™ VOID FILL SYSTEM

MODEL	SIZE (L x W x H)	WEIGHT	ELECTRICAL	CERTIFICATIONS
Floor Stand	31" x 29" x 67 - 79"	115 lbs	110-120VAC, 50/60 Hz Single Phase, 15A Service	CE, cTUVus
Table Top	29" x 16" x 37 - 49"	86 lbs		

- Anti-jamming technology
- Rapid throughput speed of 335 ft/min
- 3D shaped paper provides increased void fill efficiency
- Paper is made from 70-100% recycled content
- Choice of table or floor model adapts to any warehouse design



X-FILL™ PRO VOID FILL SYSTEM

SIZE (L x W x H)	WEIGHT	ELECTRICAL	CERTIFICATIONS
31" x 37" x 71 - 87"	207 lbs	110-120VAC, 50/60 Hz Single Phase, 15A Service	CE, cTUVus

- Anti-jamming technology
- Rapid throughput speed of 415 ft/min
- 3D shaped paper provides increased void fill efficiency
- Paper is made from 70-100% recycled content
- 4 programming modes enable variable option use



X-PAD™ CUSHIONING SYSTEM

MODEL	SIZE (L x W x H)	WEIGHT	ELECTRICAL	CERTIFICATIONS
Floor Stand	25.5" x 24.5" x 61 - 67"	192 lbs	110-120VAC, 50/60 Hz Single Phase, 15A Service	CE, cTUVus
Table Side	32" x 20.5" x 46.5"	174 lbs		

- Anti-jamming technology
- Rapid throughput speed of 180 ft/min
- Fanfold paper vs rolls, stacks and feeds much faster
- Center stitching keeps pads from unfolding
- Floor or table side models adapt to any warehouse setup
- User-friendly interface with large touch screen



PAPER OPTIONS

FOR DESIGNATED PAPER SYSTEM	PLY	BASE WEIGHT	SIZE	BUNDLES/ PALLET
X-Fill™	-	30#	15" x 1650'	60
	-	44#	15" x 1188'	60
X-Fill™ Pro	-	30#	30" x 1650'	24
X-Pad™	2	44#/44#	30" x 660'	30
	2	30#/44#	30" x 765'	30
	1	55#	30" x 990'	30
	1	44#	30" x 1188'	30



OTHER X-FILL™ PRODUCTS

PRODUCT	MODEL	SIZE (L x W x H)	WEIGHT	PAPER OUTPUT
X-Fill™ MT	Manual Table Top	20" x 16" x 31 - 37"	19.8 lbs	Manual Output & Manual Cut
X-Fill™ MM	Manual Mobile	14" x 16" x 33 - 38"	26.5 lbs	Manual Output & Manual Cut

CASE SEALING

CE-10P

WAT Case Erector

- Operator-free, automatic machine that will form a knocked down uniform-sized case
- Processes up to 10 cases per minute
- Fold four bottom flaps pneumatically in the stationary position
- Rapid case size set up with no tools or change parts
- Standard casters, case on demand eye, low tape and no tape detection
- Analog counters simplify case size set up
- Powered hopper has 48" of capacity (approx. 135-150 RSC cases)
- Up to six vacuum cups positively withdraw the case from the hopper
- Powered hopper lift
- Visual and audible alarms for case erect failure
- Pressure sensitive tape model available

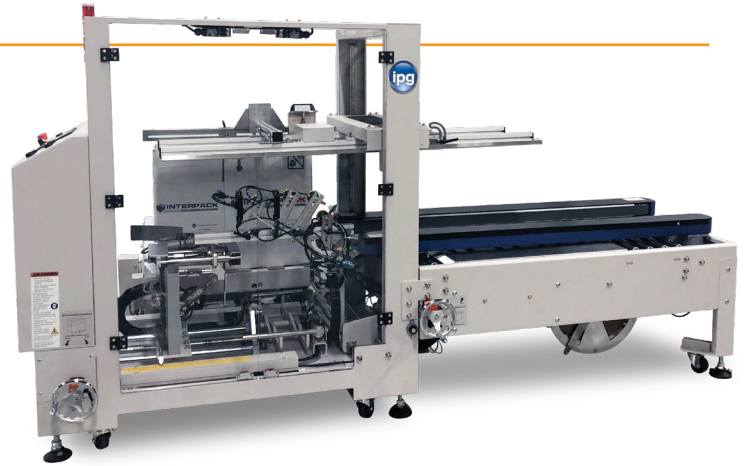

WAT CASE ERECTOR

MODEL	OPERATING RANGE				UTILITIES		TAPE	MACHINE DIMENSIONS				
	Minimum L x W x H (in)	Maximum L x W x H (in)	Case Wt (lbs)	Belt Speed (ft/min)	Electrical	Pneumatic	Tape Width (mm)	Length (in)	Width (in)	Height (in)	Conveyor Height (in)	Weight (lbs)
CE-10P WAT	10 x 7 x 5	22 x 16 x 22			110v. 1ph. 60hz. 5A. (2 x 1/4HP)	10 cfm @ 90 psi	70-78	117	97	67	24 - 27.5	2400 crated

RSA 2024-WAT

Random Auto H2O® WAT Case Sealer

- Utilizes IPG water-activated tape for the best possible seal, even on highly recycled corrugated
- Features patented wetting roller technology
- Powered tape unwind for consistent, reliable performance
- Large, up to 4500-ft tape rolls for fewer tape roll changes
- Double wipe down provides an extra secure seal
- Removable tape heads for ease of routine maintenance
- Conformable wipe down rollers maximize closure integrity
- Pneumatic indexing gate to properly position the case for processing
- Three operating modes: top & bottom taping, top only taping, bottom only taping
- Processes cases at a rate of 10-12 per minute, depending upon the case size range



Better Pack®
AutoH2O

RSA WAT CASE SEALER

MODEL	OPERATING RANGE				UTILITIES		TAPE	MACHINE DIMENSIONS				
	Minimum L x W x H (in)	Maximum L x W x H (in)	Case Wt (lbs)	Belt Speed (ft/min)	Electrical	Pneumatic	Tape Width (mm)	Length (in)	Width (in)	Height (in)	Conveyor Height (in)	Weight (lbs)
RSA 2024-WAT	6 x 6.5 x 5	Inf x 20 x 24	0 - 85	82	110v. 1ph. 60hz. 12A. (3 x 1/3HP)	9 cfm @ 90 psi	70-75	81	56	86	24 - 30	1200 crated

RSA (Random Semi-Automatic) Series

RSA Series case sealers are operator-fed machines that automatically adjust for each size case processed. When your manufacturing produces different sized cases to be processed through a single case sealer, an Interpack™ random case sealer is your answer.

RSA SERIES DATA

MODEL	OPERATING RANGE				UTILITIES		TAPE	MACHINE DIMENSIONS				
	Minimum L x W x H (in)	Maximum L x W x H (in)	Case Wt (lbs)	Belt Speed (ft/min)	Electrical	Pneumatic		Length (in)	Width (in)	Height (in)	Conveyor Height (in)	Weight (lbs)
RSA 2625-TB/2"	Standard - 6 x 6 x 2	Standard - Inf x 26 x 25	0 - 85	121	110v., 1ph., 60hz, 6A, (1/3HP, 1/4HP)	9 cfm @ 90 PSI	36-48 (1.5 - 2)	56-3/8	41-7/8	63	24 - 30	730 crated
	Factory Adjustment - 6 x 6 x 8.5	Factory Adjustment - Inf x 26 x 31.5										
RSA 2625-TB/3"	Standard - 7 x 7 x 2	Standard - Inf x 26 x 25	0 - 85	121	110v., 1ph., 60hz, 6A, (1/3HP, 1/4HP)	9 cfm @ 90 PSI	60 - 72 (2.5 - 3)	56-3/8	41-7/8	63	24 7/8 - 30	730 crated
	Factory Adjustment - 7 x 7 x 8.5	Factory Adjustment - Inf x 26 x 31.5										
RSA 2024-SB	6 x 4 x 3.5 8 x 8 x 2 opt	Inf x 20 x 24	0 - 85	82	110v., 1ph., 60hz, 6A (2 x 1/3HP)	9 cfm @ 90 PSI	36 - 48 (1.5 - 2)	44.5	47.5	73	24 - 30	650 crated
RSA 2024-SB/3"	6" x 5" x 3.5" std 8" x 8" x 2" opt	Inf x 20" x 24"	0 - 85	82	110v., 1ph., 60hz., 6A., (2 x 1/3HP)	9 cfm @ 90 PSI	48 - 72 (2 - 3)	44.5	47.5	73	24 - 30	650 crated
RSA 3036-SB	6 x 5.75 x 5	Inf x 30 x 36	0 - 85	82	110v., 1ph., 60hz, 6A (2 x 1/3HP)	9 cfm @ 90 PSI	48 - 72 (2 - 3)	44.5	47.5	83	24 - 30	816 crated

Tape Heads

Tape heads are available in standard speed and high-speed configurations to upgrade most applications. The Interpack™ brand of tape heads stand for quality, performance, reliability, and durability.

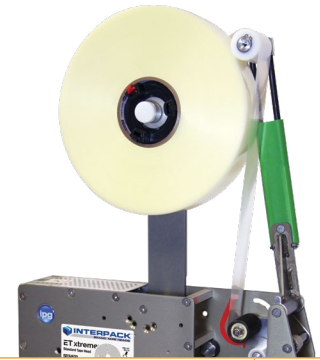

TAPE HEAD SERIES DATA

MODEL	LINE SPEED FT/MIN (M/MIN)	TAPE LEG LENGTH IN (MM)	OPTIONAL TAPE LEG LENGTH IN (MM)	TAPE WIDTH IN (MM)		MAXIMUM ROLL DIAMETER IN (MM)	TAPE HEAD DIMENSIONS IN (MM)			WEIGHT (BOXED)
				Min	Min		Length	Width	Height	
ET Xtreme 2" ET Xtreme MI 2"	120 (opt 150)	2.75 - 3 (70 - 76.2)	N/A	1.5 (36)	2 (48)	16 (406)	14.9 (378)	3.3 (84)	21.5 (546)	11 lbs
ET Xtreme 3" ET Xtreme MI 3"	115 (opt 140)	2.75 - 3 (70 - 76.2)	N/A	2.5 (60)	3 (72)	16 (406)	14.9 (378)	4.3 (109)	21.5 (546)	12 lbs
ET Xtreme LD 2"	120 (opt 150)	2.75 - 3 (70 - 76.2)	N/A	1.5 (36)	2 (48)	16 (406)	16.8 (427)	3.3 (84)	21.6 (549)	11 lbs
ET Xtreme LD 3"	115 (opt 140)	2.75 - 3 (70 - 76.2)	N/A	2.5 (60)	3 (72)	16 (406)	16.8 (427)	4.3 (109)	21.6 (549)	12 lbs
ET 2Plus 2" ET 2Plus MI 2"	90 (27.4)	2 - 2.5 (50.8 - 63.5)	N/A	1.5 (36)	2 (48)	16 (406)	14.87 (378)	3.26 (83)	14.98 (380)	19 lbs
ET 2Plus 3" ET 2Plus MI 3"	90 (27.4)	2 - 2.5 (50.8 - 63.5)	N/A	2.5 (60)	3 (72)	16 (406)	14.87 (378)	4.26 (108)	14.98 (380)	22 lbs
ET 2Plus LD	90 (27.4)	2 - 2.5 (50.8 - 63.5)	N/A	1.5 (36)	2 (48)	16 (406)	16.76 (426)	3.26 (83)	14.98 (380)	19 lbs
ET 2Plus LD 3"	90 (27.4)	2 - 2.5 (50.8 - 63.5)	N/A	2.5 (60)	3 (72)	16 (406)	16.76 (426)	4.26 (108)	14.98 (380)	22 lbs
HSD 2000-ET II 96	90 (27.4)	2-2.5 (50.8 - 63.5)	N/A	3.5 (84)	4 (96)	16 (406)	14.87 (378)	5.34 (136)	14.98 (380)	25 lbs
HSD 2000-ET II 144	90 (27.4)	2-2.5 (50.8 - 63.5)	N/A	5.5 (132)	6 (144)	16 (406)	15.67 (398)	7.91 (201)	14.98 (380)	40 lbs
HSD 2000-XS	200 (61)	2.375 (60)	2.75 (70)	1.5 (36)	2 (48)	16 (406)	24.25 (616)	4.36 (111)	23.6 (599)	29 lbs
HSD 2000-XS/3	200 (61)	2.375 (60)	2.75 (70)	2 (48)	3 (72)	16 (406)	24.25 (616)	5.36 (136)	23.6 (599)	32 lbs
HSD 2000-XS MIRROR	200 (61)	2.375 (60)	2.75 (70)	1.5 (36)	2 (48)	16 (406)	24.25 (616)	4.36 (111)	23.6 (599)	29 lbs
HSD 2000-XS/3 MIRROR	200 (61)	2.375 (60)	2.75 (70)	2 (48)	3 (72)	16 (406)	24.25 (616)	5.36 (136)	23.6 (599)	32 lbs

CASE SEALING

WAT (Water-Activated Tape) Dispensers

As the market leader for water-activated carton sealing tape, IPG's commitment continues with state-of-the-art tabletop dispensers. Wide selection of models available depending upon application and volume.

BETTER PACK® 555e SERIES

Electric Water-Activated Tape Dispenser

- Tape output of 45" (114.3cm) per second
- User-friendly, color-coded keypad with 14 preset buttons
- 1,000 foot roll tape capacity means fewer changeovers; less downtime
- Optional accessories to enhance productivity and efficiency
- UL Listed, CE and CSA certified and RoHS compliant*
- Heavy-duty, self-oiling blade for perfect, consistent cutting

* Certificate Copies Available Upon Request



BETTER PACK® 333PLUS

Manual Water-Activated Tape Dispenser

- Perfect for light-to medium-volume packaging areas
- Accommodates both reinforced or non-reinforced water-activated tape
- It is available as a non-electrical unit and also with an optional top heater accessory (electricity required), when increased tape adhesion is needed
- Quickly choose one of 15 preset tape lengths on clearly marked dial



CURBY® MINI-TAPER

Manual Water-Activated Tape Dispenser

- Weighing only 6 pounds, it is perfect for small office or home office, retail outlets and low-volume shipping environments with limited workspace
- Soft touch tape delivery and easy push tape dispensing
- Better Pack water brushes provide consistent, uniform tape wetting



Tape Dispensers

If you're using short rolls of pressure-sensitive carton sealing tapes for shipping, packing, moving or other applications, we have a solution of hand-held dispensers in many sizes and types for your needs.

MOUSETRAP HAND DISPENSERS

Designed to fit tape with any size core and are excellent for applying carton sealing, filament, masking, flatback tapes and more. Reduces noise and is quieter on the tape unwind.

PISTOL GRIP HAND DISPENSERS

Ergonomically designed to reduce fatigue and provides a comfort molded finger grip.

MOUSETRAP HAND DISPENSERS

STYLE	DESCRIPTION	GRADE	CORE DIAMETER	MAX WIDTH OF TAPE	MAX DIAMETER OF TAPE	COLOR	MOQ
			inches	inches	inches		
1976	Heavy duty construction; comfortable rubberized molded finger grip handle ; natural rubber roller holds tape during application; heavy gauge steel blade; flexible poly tape wiper ; durable, lightweight, ergonomically correct	Premium	3	2	5	Blue	24
1983	Heavy duty construction; comfortable rubberized molded finger grip handle ; natural rubber roller holds tape during application; heavy gauge steel blade; flexible poly tape wiper ; durable, lightweight, ergonomically correct	Premium	3	3	5	Blue	24
1975	Lightweight steel frame with high impact plastic; natural rubber roller holds tape during application; heat treated steel blade; plastic wiper	Utility	3	2	6	Red	24
1977	Lightweight steel frame with high impact plastic; natural rubber roller holds tape during application; heat treated steel blade; plastic wiper	Utility	3	3	6	Red	24

PISTOL GRIP HAND DISPENSERS

STYLE	DESCRIPTION	GRADE	CORE DIAMETER	MAX WIDTH OF TAPE	MAX DIAMETER OF TAPE	COLOR	MOQ
			inches	inches	inches		
1973	For heavy steel construction; natural rubber roller holds tape during application; heavy gauge reversible steel blade; adjustable friction tension brake for the tape roll; spring loaded tape gate	Premium	3	2	5	Blue	30
1974	For heavy steel construction; natural rubber roller holds tape during application; heavy gauge reversible steel blade; adjustable friction tension brake for the tape roll; spring loaded tape gate	Premium	3	3	5	Blue	20
1969	Reinforced steel frame with high impact plastic; natural rubber roller holds tape during application; heat treated steel blade; adjustable brake for tension control; plastic loading gate; plastic wiper	Medium	3	2	5	Blue	24
1970	Reinforced steel frame with high impact plastic; natural rubber roller holds tape during application; heat treated steel blade; adjustable brake for tension control; plastic loading gate; plastic wiper	Medium	3	3	4.75	Blue	24
1985	Lightweight steel frame with high impact plastic; plastic roller; heavy gauge reversible steel blade; adjustable friction tension brake for the tape roll; spring loaded tape gate; flexible poly tape wiper	Utility	3	2	5.25	Blue	24
1972	Lightweight steel frame with high impact plastic; plastic roller; heavy gauge reversible steel blade; adjustable friction tension brake for the tape roll; spring loaded tape gate; flexible poly tape wiper	Utility	3	3	5.5	Blue	20
TPX48NP	XTRAtape™; Fit 1.5" ID core; reinforce steel frame with high impact plastic; plastic roller; adjustable brake for tension control; plastic wiper	Medium	1.5	2	4.76	Blue	24

PACKAGING TAPES

IPG has a full line of pressure-sensitive carton-sealing tapes with all three adhesive technologies, as well as paper and reinforced water-activated tapes. We also offer Corru-Grip® hot melt carton sealing tape designed specifically for optimal closure of highly recycled corrugate, including 100% recycled boxes. The Corru-Grip adhesive formulation also successfully seals boxes in wider ranges of temperature and humidity than traditional hot melt carton sealing tape products. As a leader in the carton sealing tape market, IPG combines years of experience as a prime manufacturer of superior quality tape to the industrial and retail channels.

Hot Melt Adhesive Tapes

IPG's hot melt carton sealing tapes offer the widest range of application flexibility available. They offer excellent processing performance, whether manually or automatically applied. Their superior adhesion properties, holding force, tensile strength and easy unwind ensure consistent, reliable seals to variety of corrugated and linerboard boxes. IPG's Clear Hot Melt Carton Sealing Tapes are Cradle to Cradle Certified® Bronze*.



HOT MELT

STYLE	DESCRIPTION	COLOR	THICKNESS	PEEL ADHESION D-3330	TENSILE STRENGTH MD D-3759	ELONGATION MD D-3759	HOLDING POWER TO LINER BOARD D-3654
			mil	oz/in of width	lb/in of width	% at break	min
1100	Premium grade hot melt with Corru-Grip; extra heavy weight box sealing, under- or over-stuffed boxes, package repair and bundling	Clear, Tan**	3.0	46.0	32.0	150	40,000
9100	Premium grade hot melt with Corru-Grip; heavy weight or bulky box sealing	Clear, Tan**	2.5	44.0	30.0	140	30,000
8100	Medium grade hot melt with Corru-Grip; medium weight box sealing	Clear, Tan**	2.2	42.0	26.0	135	22,000
7205	Medium grade hot melt with Corru-Grip; medium weight box sealing	Clear	2.05	42.0	24.0	130	14,000
7151QT	Cold temp medium grade; medium weight box sealing in cooler food packaging/processing and moving/ storage applications	Clear, Tan**	1.95	26.0	HL 27.0 ML 22.0	HL 85 ML 120	4,000
7100	Medium grade; medium weight box sealing	Clear, Tan**	HL 1.85 ML 1.90	32.0	HL 27.0 ML 22.0	HL 85 ML 120	HL 7,000 ML 7,500
6151QT	Cold temp utility grade; light to medium weight box sealing in cooler food packaging/processing & moving/ storage applications	Clear	1.7	25.0	HL 25.0 ML 19.0	HL 80 ML 125	2,500
6100	Utility grade; light to medium weight box sealing	Clear, Tan**	1.6	32.0	HL 25.0 ML 19.0	HL 80 ML 125	5,000
6100LPT	For shipping label protection, edge reinforcing, splicing, hinging, tabbing	Clear	1.6	30.0	23.0	80	5,000
6122	Utility grade; light weight box sealing	Clear, Tan**	1.5	HL 25.0 ML 23.0	HL 22.0 ML 18.0	HL 80 MI 120	4,000
5135	Utility grade; light weight box sealing	Clear	1.35	HL 23.0 ML 21.0	HL 22.0 ML 18.0	HL 80 ML 120	3,000
780PET	Specialty PET; extra heavy weight box sealing, under- or over-stuffed boxes, package repair and bundling	Clear	3.0	65.0	55.0	100	85,000

*For more information visit www.itape.com/c2c

** Limited sizes available in tan as a non-stock, make-to-order item.

PACKAGING TAPES

HOT MELT SIZES

STYLE		1100			9100				8100			7205	
HAND LENGTH	mm x m	48 x 55	48 x 100	72 x 55	48 x 55	48 x 100	72 x 55	72 x 100	48 x 100	72 x 100	48 x 100	72 x 100	
	rolls/carton	36	36	24	36	36	24	24	36	24	36	24	
MACHINE LENGTH	mm x m	48 x 914	72 x 914		48 x 914		72 x 914		48 x 914	72 x 914	72 x 1371	48 x 914	72 x 914
	rolls/carton	6	4		6		4		6	4	4	6	4

STYLE		7151QT					7100						
HAND LENGTH	mm x m	48 x 100			72 x 100		48 x 50		48 x 100	48 x 200		72 x 100	
	rolls/carton	36			24		36		36	36		24	
MACHINE LENGTH	mm x m	48 x 914	48 x 1371	48 x 1500	48 x 1828	72 x 914	48 x 914	48 x 1371	48 x 1500	48 x 1828	72 x 914	72 x 1371	72 x 1500
	rolls/carton	6	6	6	4	4	6	6	6	4	4	4	4

STYLE		6151QT					6100						
HAND LENGTH	mm x m	48 x 100			72 x 100		48 x 50		48 x 100	48 x 200		72 x 100	
	rolls/carton	36			24		36		36	36		24	
MACHINE LENGTH	mm x m	48 x 914	48 x 1371	48 x 1500	48 x 1828	72 x 914	48 x 914	48 x 1371	48 x 1828	72 x 914	72 x 1371	72 x 1828	
	rolls/carton	6	6	6	4	4	6	6	4	4	4	4	

STYLE		6100LPT		6122		5135			780PET	
HAND LENGTH	mm x m	96 x 66	144 x 66	48 x 100	72 x 100	48 x 50	48 x 100	72 x 100	48 x 55	72 x 55
	rolls/carton	18	12	36	24	36	36	24	36	24
MACHINE LENGTH	mm x m	-		48 x 914	72 x 914	48 x 914			48 x 914	72 x 914
	rolls/carton	-		6	4	6			6	4



PACKAGING TAPES

Acrylic Adhesive Tapes

IPG's acrylic carton sealing tapes are best suited for reliable, all-temperature box sealing performance (less than 40°F and greater than 120°F) where resistance to aging, weathering, UV light and yellowing are important. They also provide excellent clarity, high shear strength to prevent "flagging", superior quick stick performance and controlled unwind to facilitate dispensing on manual or automatic case sealing machines. IPG's Clear Acrylic Carton Sealing Tapes are Cradle to Cradle Certified® Bronze*.



ACRYLIC

STYLE	DESCRIPTION	COLOR	THICKNESS	PEEL ADHESION D-3330	TENSILE STRENGTH MD D-3759	ELONGATION MD D-3759
			mil	oz/in of width	lb/in of width	% at break
341	Premium grade; heavy weight or bulky box sealing	Clear	3.0	22.0	32.0	180
291	Premium grade; heavy weight or bulky box sealing	Clear	2.5	21.0	28.0	150
400	Medium grade; medium weight box sealing	Clear, Tan**	2.1	20.0	HL 26.0 ML 22.0	HL 85 ML 120
321	Medium grade; medium weight box sealing	Black, Blue, Green, Orange, Red, White, Yellow	2.1	20.0	HL 26.0 ML 22.0	HL 85 ML 120
191	Medium grade; medium weight box sealing	Clear	1.91	18.0	HL 26.0 ML 22.0	HL 85 ML 120
300	Utility grade; light to medium weight box sealing	Clear, Tan**	1.85	HL 87.0 ML 18.0	HL 23.0 ML 19.0	HL 80 ML 120
170	Utility grade; light weight box sealing	HL Clear, Tan** ML Clear	1.75	16.0	HL 23.0 ML 19.0	HL 80 ML 120
170E	Utility grade; light weight box sealing; Film is made with 30% post-industrial recycled content; Lower carbon footprint than traditional carton sealing tapes	Clear	1.75	16.0	15.0	>100
161	Utility grade; light weight box sealing	Clear	1.61	14.0	HL 23.0 ML 19.0	HL 80 ML 120
291CTTC	Clear-to-the-Core®; specialty; medium weight box sealing	Clear	2.7	21.0	28.0	150
130WS	Whisper Smooth®; specialty; medium weight box sealing	Clear	2.0	20.0	26.0	130

*For more information visit www.itape.com/c2c

** Limited sizes available in tan as a non-stock, make-to-order item.

PACKAGING TAPES

ACRYLIC SIZES

STYLE		191		300			170			170E	161	291CTTC	130WS	
HAND LENGTH	mm x m	48 x 100	72 x 100	48 x 50	48 x 100	72 x 100	48 x 50	48 x 100	72 x 100	48 x 100	48 x 100	48 x 50	48 x 100	72 x 114
	rolls/ carton	36	24	36	36	24	36	36	24	36	36	36	36	24
MACHINE LENGTH	mm x m	48 x 914	48 x 1371	72 x 914	48 x 914		48 x 914	48 x 1371	72 x 914	48 x 914	48 x 914	-	-	
	rolls/ carton	6	6	4	6		6	6	4	6	6	-	-	

STYLE		341		291				400				321	
HAND LENGTH	mm x m	48 x 55	72 x 55	48 x 55	48 x 100	72 x 55	72 x 100	48 x 50	48 x 100		72 x 100	48 x 100	72 x 100
	rolls/ carton	36	24	36	36	24	24	36	36		24	36	24
MACHINE LENGTH	mm x m	-	-	48 x 914				48 x 914	48 x 1371	48 x 1500	48 x 1828	72 x 914	48 x 914
	rolls/ carton	-	-	6				6	6	6	6	4	6



PACKAGING TAPES

Natural Rubber Adhesive Tapes

IPG's Central® natural rubber carton sealing tapes have the most aggressive adhesive available. They offer fast, positive bonding on problem applications such as high recycled content cartons, rough or ultra-smooth cartons, heavy ink coverage, dusty and/or dirty environments, humid conditions and temperature extremes.

CENTRAL®



NATURAL RUBBER

STYLE	DESCRIPTION	COLOR	THICKNESS	PEEL ADHESION D-3330	TENSILE STRENGTH MD D-3759	ELONGATION MD D-3759
			mil	oz/in of width	lb/in of width	% at break
520	Premium grade; extra heavy duty box sealing	Clear	2.8	23.0	33.0	175
510	Premium grade; heavy duty box sealing	Clear	2.3	21.0	29.0	175
500	Medium grade; medium weight box sealing	HL Clear, Tan**, White (48mm x 100m only) ML Clear	1.9	19.0	24.0	140
570	Utility grade; light to medium weight box sealing	Clear, Tan**	1.6	19.0	20.0	125

** Limited sizes available in tan as a non-stock, make-to-order item.

NATURAL RUBBER SIZES

STYLE		520			510		
HAND LENGTH	mm x m	48 x 55	48 x 100	72 x 100	48 x 50	48 x 100	72 x 100
	rolls/carton	36	36	24	36	36	24
MACHINE LENGTH	mm x m	-			48 x 914		
	rolls/carton	-			6		

STYLE		500		570		
HAND LENGTH	mm x m	48 x 50	48 x 100	48 x 50	48 x 100	72 x 100
	rolls/carton	36	36	36	36	24
MACHINE LENGTH	mm x m	48 x 914	72 x 914	-		
	rolls/carton	6	4	-		

Flatback Tapes

IPG's flatback tape (pressure-sensitive paper tape, kraft paper tape) is designed for superior performance in a variety of packaging and carton closure applications. They provide a quick positive seal under a wide range of temperature and humidity conditions. Most of IPG's flatback tapes are hand tearable and also can be used with a variety of tape dispensers and case sealing machines.



FLATBACK

STYLE	DESCRIPTION	COLOR	THICKNESS	ADHESION TO STEEL PSTC-101	TENSILE STRENGTH MD D-3759	ELONGATION MD D-3759
			mil	oz/in of width	lb/in of width	% at break
100e	Aggressive paper carton sealing tape made with 100% recycled paper; FSC™ certified; hand tearable; excellent quick tack; easy unwind.	Brown	4.7	72.0	23.0	4
539	Low curl; highly conformable tape; designed for carton sealing and use with automatic tape heads; meets U.S. Postal and UPS shipping requirements	Brown	7.3	85.0	42.0	7
525	An aggressive pressure-sensitive flatback with an adhesive that has been specifically designed to offer a strong and secure seal on a variety of substrates	Brown	5.5	55.0	34.0	3

FLATBACK SIZES

STYLE		100e		539		525	
HAND LENGTH	mm x m	48 x 55	72 x 55	48 x 54.8	72 x 54.8	48 x 54.8	72 x 54.8
	rolls/carton	36	24	24	16	24	16
MACHINE LENGTH	mm x yd	48 x 500	72 x 500	48 x 480	72 x 420	48 x 438.9	72 x 438.9
	rolls/carton	6	4	6	4	6	4



PACKAGING TAPES

Water-Activated Tape (WAT)

Water-activated tapes (WAT) bond instantly to both virgin and recycled fiber surfaces and therefore, generates an immediate destructive bond resulting in a tamper evident package. WAT is offered in both fiberglass reinforced and plain paper with many styles available in standard prints or customized prints to display your corporate message. All of IPG's WAT is recyclable with the carton it is applied on. When you use IPG's WAT tape to seal the carton, the paper from the tape contributes to the recycling stream with the corrugate. IPG is proud to announce our line of water-activated tapes has achieved **Cradle to Cradle Certified® Bronze level***.



CENTRAL



CENTRAL® REINFORCED TAPES

STYLE	DESCRIPTION	WIDTHS	TOP/BOTTOM PAPER WEIGHT	BASIS REINFORCEMENT	COLORS	ROLLS PER CASE	CASES PER PALLET
		inches	lbs/lbs				
280	Recommended uses: two strip carton sealing (top & bottom), overstuffed cartons, recycled cartons, non-unitized loads, heavyweight cartons up to 90 lbs.	3	30/30	MD - (3-3-2-2-3-3) 75 fiberglass on 1/2" spacing CD - (1-1-1) 150 fiberglass on .55" spacing	Natural	3" - 450' - 10 PACK	60
270	Recommended uses: two strip carton sealing (top & bottom), overstuffed cartons, recycled cartons, non-unitized loads, average to heavyweight cartons up to 65 lbs.	2 1/2	25/30	MD - (2-2-1-1-2-2) 75 fiberglass on 1/2" spacing CD - (1-1-1) 150 fiberglass on .55" spacing	Natural	2 1/2" - 450' - 12 PACK	60
		3	25/30		Snow-White	3" - 375' - 8 PACK	84
						3" - 450' - 10 PACK	60
260	Recommended uses: two strip carton sealing (top & bottom), non-unitized loads, average weight cartons up to 55 lbs.	2 1/2 3	25/25 25/25 25/25	MD - (2-1-1-1-1-2) 75 fiberglass on 1/2" spacing CD - (1-1-1) 150 fiberglass on 1.10" spacing	Natural Snow-White Super-White	2.5" - 450' - 12 PACK	63
						3" - 375' - 8 PACK	84
						3" - 450' - 10 PACK	63
						3" - 500' - 6 PACK	60
						3" - 500' - 10 PACK	60
						3" - 900' - 6 PACK	50
240	Recommended uses: two strip carton sealing (top & bottom), recycled cartons, non-unitized loads, light to average weight cartons up to 30 lbs.	60mm 72mm	23/23 25/23	MD - (1-1-1-1-1) 75 fiberglass on 1/2" spacing CD - (1-1-1) polyester on 1.10" spacing	Natural Snow-White	60mm - 600' - 12 PACK	60
						72mm - 375' - 8 PACK	84
						72mm - 450' - 10 PACK	63
						72mm - 500' - 6 PACK	60
						72mm - 600' - 10 PACK	60
						72mm - 1000' - 6 PACK	50
235	Recommended uses: two strip carton sealing (top & bottom), recycled cartons, non-unitized loads, light to average weight cartons up to 25 lbs.	60mm 72mm	23/23 25/23	MD - (1-1-1-1-1) 110 fiberglass on 1/2" spacing CD - (1-1-1) polyester on 1.10" spacing	Natural Snow-White	60mm - 450' - 12 PACK	63
						60mm - 600' - 12 PACK	60
						70mm - 375' - 8 PACK	84
						70mm - 450' - 10 PACK	63
						70mm - 500' - 6 PACK	60
						70mm - 600' - 10 PACK	60

*For more information visit www.itape.com/c2c

PACKAGING TAPES

REINFORCED TAPES

STYLE	DESCRIPTION	WIDTHS	TOP/BOTTOM PAPER WEIGHT	BASIS REINFORCEMENT	COLORS	ROLLS PER CASE	CASES PER PALLET
		inches	lbs/lbs				
VENOM®	Recommended uses: two strip carton sealing (top & bottom), recycled cartons, non-unitized loads, light weight cartons up to 20 lbs.	60mm 70mm	20/23	MD - (1-1-1-1 per 70mm) 110 fiberglass on .625" (5/8") centers CD - (1-1-1) polyester on 1.10" spacing	Natural	60mm - 450' - 12 PACK	60
						70mm - 375' - 8 PACK	84
						70mm - 450' - 10 PACK	63
						70mm - 500' - 6 PACK	63
						70mm - 600' - 10 PACK	60
						70mm - 1000' - 6 PACK	50

Certified Recyclable WAT Paper Tape (Unreinforced)

Our WAT paper tape has passed the Western Michigan University Old Corrugated Cardboard (OCC) Equivalency (WMU OCC-E) testing protocol making it the first certified recyclable carton sealing tape! These products, without reinforcing fibers, are completely made from recyclable paper.



CENTRAL

CENTRAL® PAPER TAPES

STYLE	DESCRIPTION	GRADE	WIDTHS	PAPER WEIGHT	COLORS	ROLLS PER CASE	CASES PER PALLET
			inches	lbs			
190	Recommended uses: Sealing medium weight cartons, including regular slotted containers, full overlap, telescope and others. As a dust seal or for in-plant use. Carton sealing for unitized cartons (pallets). Paper splicing and food products packaging. Use when high strength or reinforced tape is not required.	Heavy Duty	2	78 90	Natural White	2" - 375' - GSI-14 PACK	60
			2½			2½" - 375' - GSI-12 PACK	60
			3			3" - 375' - GSI-10 PACK	60
160	Recommended uses: Sealing lightweight cartons, including regular slotted containers, full overlap, telescope and others. As a dust seal or for in-plant use. Packing for food and textile industries, splicing of recycled webs, packing of unitized cartons (pallets).	Medium Duty	2	57 55	Natural White	2" - 600' - GSI-14 PACK	60
			2½			2½" - 600' - GSI-12 PACK	60
			3			3" - 600' - GSI-10 PACK	60
			4			4" - 600' - GSI-6 PACK	60
			6			6" - 600' - GSI-4 PACK	60
160 Green Core	Recommended uses: Sealing lightweight cartons, including regular slotted containers, full overlap, telescope and others. As a dust seal or for in-plant use. Packing for food and textile industries, splicing of recycled webs, packing of unitized cartons (pallets).	50% recycled fibers Medium Duty	60mm, 70mm	57	Natural	60mm - 600' - GSI-12 PACK	60
						70mm - 600' - GSI-10 PACK	60
140	Recommended uses: To pack a lightweight inner carton in a master carton. To seal retail carry-out packages. Retail gift wrap stations. As a dust seal. Delicatessens, meat and produce packaging. To tape and hold assembly packaging.	Light Duty	1	40 35	Natural White	1" - 500' - GSO-30 PACK	63
			1¼			1¼" - 500' - GSO-24 PACK	63
			1½			1½" - 500' - GSO-20 PACK	63

FILMS

Packaging requires bundling loads and unitizing pallets in order to complete the shipping process. Widgets find their way into boxes and boxes find a way onto pallets. Securing the contents of those boxes to the pallets with stretch film makes up part of the solutions from IPG. Over the years, IPG acquired the ability to produce both blown and cast stretch film. IPG knows how important security is to you. Our full line of bundling and unitizing solutions will keep your products secure through your supply chain process.

IPG's SuperFLEX® and StretchFLEX® stretch films became **Cradle to Cradle Certified Silver***, becoming the first stretch wrap products to be Cradle to Cradle Certified!



Machine Applied Stretch Film

IPG's SuperFLEX® brand high performance stretch brand products are light gauge stretch films used to effectively replace traditional heavier gauge stretch film.



GENESYS® ULTRA PLUS

- Superior load containment and the highest ultimate stretch available while further reducing gauge
- Most consistent stretch force application in the industry
- Remarkable clarity with a high gloss finish
- Produced in 37, 41, 45, and 48 gauges
- Metric widths only; 500mm and 750mm
- Most gauges are available in two different roll diameters

GENESYS®

- High performance stretch film for high performance applications.
- Offers high load containment
- Excellent puncture / tear resistance
- High cling / slip all while stretching on high speed stretch wrappers at pre-stretch levels up to 300% and beyond
- High clarity and cling
- Produced in gauges from 50 up to 95.
- Standard widths are 20" and 30"
- Roll diameters from 8" to 10"

SSC

- Machine cast film designed for applications needing more cling and slip to protect the load
- SSC has long term success in working in a variety of tough application due to load configurations or equipment limitations
- Available in gauges from 50 to 120
- Standard widths are 20" and 30"
- Roll diameters from 8" to 10"

GENESYS® ULTRA

- High performance stretch film for demanding previous heavier gauge applications
- Offers high pre-stretch levels with adjustable load containment for a variety of demanding applications
- Manufactured on state-of-the-art cast extrusion lines
- High clarity and cling
- Produced in gauges from 39 to 50
- Standard widths include 20" and 30"
- Roll diameters from 8" to 10"

SF1

- Machine cast film designed for a variety of machine film applications
- SF1 has high pre-stretch while preventing breaks during the wrap cycle and spills during transportation
- Differential cling for reduced ability for load sticking together
- High quality cast film
- Available in gauges from 50 to 120
- Standard widths are 20" and 30"
- Roll diameters from 8" to 10"

SF3

- Tough, biaxially oriented blown film for applications requiring excellent cling and puncture resistance
- SF3 is a standard high performance blown film for customers who expect aggressive cling and improved puncture for their demanding loads
- Available in gauges from 50 to 110
- Standard widths are 20" and 30"
- Roll diameters from 8" to 10"

Hand Wrap Stretch Film

IPG's StretchFLEX® brand standard duty stretch brand products have a reputation for reliability and consistency. StretchFLEX products are the right choice for applications where heavier gauge films make sense. IPG produces both cast and blown stretch film in our modern stretch production facilities.



ORBIT AIR B

- A strong and tough biaxially oriented pre-stretched film for superior strength
- Edges are reinforced to prevent tearing during unwind
- High cling for easy application
- Superior holding force to prevent load shifting during transit
- Less effort to wrap your load securely
- Widths are 14.5" & 17"

PROLITE®

- 5-layer stiff cast hand wrap designed for easy down gauging and cost savings over thicker standard hand wrap films
- Maintains load containment while reducing film usage
- Easy to apply and easy wipe down of the tail
- Available in gauges from 40 to 60
- Widths available from 14" to 18"

HWIV

- Multilayer cast hand wrap
- Great cling and clarity
- Ease of use with great containment
- Quiet release
- Available in gauges from 60 to 90
- Available in widths from 12" to 18"

HWII

- Blown hand wrap
- Aggressive cling
- Excellent load containment
- Great puncture
- Available in gauges from 60 to 120
- Available in widths from 12" to 18"

EXPRESSWRAP™

- Narrow width and extended core cast film
- Available in 80 gauge
- Available in widths 3" & 5" and extended core 20"



FILMS

Shrink Film

IPG's Exlfilm® and Exlfilmplus® are a leading line of premium shrink film in the packaging industry. Our experienced team of technical sales professionals can provide solutions to reduce packaging costs, improve package appearance, and increase output.

IPG's Exlfilmplus GPS, Exlfilmplus GPL, and Exlfilmplus SHIELD are Cradle to Cradle Certified® Silver*. These films are the first Cradle to Cradle certified shrink films in the world.



EXLFILMplus® GPL

- Ultra light gauge
- Lowest cost per package
- Excellent machinability
- Superior clarity and gloss
- Minimal shrink force
- Consistently strong seals
- Crosslinked technology
- FDA compliant
- Pre-perforated film available
- Available on 3" or 6" core

EXLFILMplus® GPS

- Wide window of operation
- Superior sealing performance
- Higher shrink force
- Printable
- FDA compliant
- Excellent machinability
- Crosslinked technology
- Pre-perforated film available
- Available on 3" or 6" core

EXLFILMplus® SHIELD

- Fully opaque gray film maintains the confidentiality of sensitive documents and high dollar products
- Eliminates the corrugated shipping container and void fill when packaging items strong enough to withstand the rigors of shipping
- Designed for fulfillment houses and e-commerce shippers delivering product to the consumer
- High speed pack off for improved output rates and lower labor costs
- Crosslinked Technology provides consistent sealing and shrinking
- Printable for enhanced marketing opportunities



PRODUCT APPLICATIONS

- Wrapping of confidential items such as insurance policies, annual reports and other sensitive documents and deliveries
- Concealment of high dollar products (e.g. high-end auto components, electronics or jewelry)
- Packaging of items that can withstand the rigors of shipping without the corrugated shipping container (e.g. shoes)



*For more information visit www.itape.com/c2c

IPG's diverse line of mailers are easy to use and are a more cost effective alternative to other containers. These mailers increase productivity, offer higher levels of security while helping to decrease your current shipping costs. IPG stocks standard sizes and offers many different custom options.



Now introducing the **Curby Mailer™**, a recyclable paper mailer. The Curby Mailer line are **Cradle to Cradle Certified® Silver***. This mailer is lined with an innovative honeycomb paper structure - patent pending cushioning material that offers substantial benefits over traditional wrapping materials.

ECOLITE® MAILER

Kraft Bubble Mailer

PRODUCT NUMBER	MAILER SIZE	USABLE SIZE	MAILERS/CARTON
ELSS000	4" x 8"	4" x 7"	500
ELSS00	5" x 10"	5" x 9"	250
ELSS0	6.5" x 10"	6.25" x 9"	250
ELSS1	7.25" x 12"	7" x 11"	100
ELSS2	8.5" x 12"	8.25" x 11"	100
ELSS3	8.5" x 14.5"	8.25" x 13.5"	100
ELSS4	9.5" x 14.5"	9.25" x 13.5"	100
ELSS5	10.5" x 16"	10.25" x 15"	100
ELSS6	12.5" x 19"	12.25" x 18"	50
ELSS7	14.25" x 20"	14" x 19"	50

FASTPAK® MAILER

Polyethylene Courier Mailer

PRODUCT NUMBER	MAILER SIZE	MAILERS/CARTON
FP6X9	6" x 9"	1000
FP7.5X10.5	7.5" x 10.5"	1000
FP9X12	9" x 12"	500
FP10X13	10" x 13"	500
FP12X15.5	12" x 15.5"	500
FP14.5X19	14.5" x 19"	250
FP19X24	19" x 24"	125
FP24X24	24" x 24"	125

XPAK® MAILER

Polyethylene Bubble Mailer

PRODUCT NUMBER	MAILER SIZE	USABLE SIZE	MAILERS/CARTON
XPAK000	4" x 8"	4" x 7"	500
XPAK00	5" x 10"	5" x 9"	250
XPAK0	6" x 10"	6" x 9"	250
XPAK1	7.25" x 12"	7" x 11"	100
XPAK2	8.5" x 12"	8.25" x 11"	100
XPAK3	8.5" x 14.5"	8.25" x 13.5"	100
XPAK4	9.5" x 14.5"	9.25" x 13.5"	100
XPAK5	10.5" x 16"	10.25" x 15"	100
XPAK6	12.5" x 19"	12.25" x 18"	50
XPAK7	14.25" x 20"	14" x 19"	50

CURBY MAILER™

Curbside Recyclable Paper Mailer

PRODUCT NUMBER	MAILER SIZE	MAILERS/CASE
CURBY2SL	9.875" x 9.5"	80
CURBY5	9.875" x 15.5"	80
CURBY6	11.875" x 18.5"	80



*For more information visit www.itape.com/c2c

BRANDING & SECURITY

Want to showcase your brand? Looking for new advertising space? IPG has the solution for you. We have a variety of printable packaging tapes and the ability to custom print on most of our pressure-sensitive tapes. Our water-activated tape printing capability is unparalleled. The Custom Print Program enhances product offerings to the end-user that separates their product from the competition. Whatever message you want your container to say, IPG can help you carry your message!



Water-Activated Adhesive Tapes

CUSTOM PRINT PROGRAM

GUIDELINES

- Designs can be up to three (3) standard inks (PMS color matching and custom art and layout services are available).
- Printing plates are the property of Intertape Polymer Group® and are retained for three (3) years after the last order.
- Seamless flood-coating available; please inquire for specific tooling charges.
- Varnish coating is recommended for flood-coats in black and blue. Varnish coating is treated as an additional ink color (eg. 3 max).
- Borders: When not bleeding off the edge, 1/16" top/bottom edge for anything below 180 cases and 3/16" for 180+ cases.
- Fluorescent and metallic inks are not recommended due to poor water resistance and fade resistance.

STANDARD INKS (PMS EQUIVALENTS*)

BLACK	*GRAY GCM1 970	WHITE	RED PMS186U	DARK GREEN PMS356U	BRIGHT GREEN PMS355U	DARK BLUE PMS288U	LIGHT BLUE PMS3005U	BRIGHT BLUE PMS286U
BROWN PMS4695U	ORANGE PMS151U	YELLOW PMS108U	MAROON PMS207U	NOTE: Due to variations in computer generated reproductions, the standard ink colors displayed may vary from our production ink colors. *Standard gray is a GCM1 color and not a Pantone color.				

STOCK DESIGNS

STYLE	GRADE	PRINTED MESSAGE	WIDTH x LENGTH		ROLLS PER CASE	CASES PER PALLET
			inches	feet		
K3559P202	260	Crafted with Pride	3	600	10	60
K7000P426	240	Made in the USA	72mm	450	10	63
K2034P190	140	Not For Sale	1	500	30	63
K2034P191	140	Thank You	1	500	30	63

BRANDING & SECURITY

DIAGONAL STRIPES

STYLE	GRADE	COLORS	WIDTH x LENGTH		ROLLS PER CASE	CASES PER PALLET
			inches	feet		
K2137P050	#160 Medium Duty Paper	Red	2.5	600	12	60
K2137P055	#160 Medium Duty Paper	Bright Green	2.5	600	12	60
K2137P058	#160 Medium Duty Paper	Yellow	2.5	600	12	60
K2137P057	#160 Medium Duty Paper	Orange	2.5	600	12	60
K2137P052	#160 Medium Duty Paper	Bright Blue	2.5	600	12	60
K2139P050	#160 Medium Duty Paper	Red	3	600	10	60
K2139P055	#160 Medium Duty Paper	Bright Green	3	600	10	60
K2139P058	#160 Medium Duty Paper	Yellow	3	600	10	60
K2139P057	#160 Medium Duty Paper	Orange	3	600	10	60
K2139P052	#160 Medium Duty Paper	Bright Blue	3	600	10	60

SOLID COLORS

STYLE	GRADE	COLORS	WIDTH x LENGTH		ROLLS PER CASE	CASES PER PALLET
			inches	feet		
K7450P144	#260 Reinforced	Red	3	450	10	63
K7453P795	#260 Reinforced	Green	3	450	10	63
K7453P797	#260 Reinforced	Yellow	3	450	10	63
K2763P001	#260 Reinforced	Pale Blue	3	450	10	63
K2125P047	#160 Medium Duty Paper	Red	2.5	600	12	60
K2876P581	#160 Medium Duty Paper	Green	2.5	600	12	60
K2202P032	#160 Medium Duty Paper	Yellow	2.5	600	12	60
K2876P580	#160 Medium Duty Paper	Orange	2.5	600	12	60
K2799P615	#160 Medium Duty Paper	Pale Blue	2.5	600	12	60
K2800P756	#160 Medium Duty Paper	Red	3	600	10	60
K2867P624	#160 Medium Duty Paper	Green	3	600	10	60
K2867P621	#160 Medium Duty Paper	Yellow	3	600	10	60
K2867P623	#160 Medium Duty Paper	Orange	3	600	10	60
K2800P713	#160 Medium Duty Paper	Pale Blue	3	600	10	60

BRANDING & SECURITY

Pressure-Sensitive Adhesive Tapes

IPG's iPrint™ hot melt surface print program utilizes our 7100 hot melt carton sealing tape for one color print with standard images and inks. We can also print your own message right on the tape as well!

CUSTOM PRINT PROGRAM

PMS COLOR MATCHES

- Upcharge of 25% to base, per color

ARTWORK AND PLATES

- No charge for the first color
- \$35 per each width and per each color for second and third color
- Artwork must be created in a vector based program (Illustrator) and saved as a PDF
- Maximum height: 32mm for 48mm wide tape, 56mm for 72mm wide tape
- PDF color proofs emailed for customer approval, prior to printing
- Packed in plain kraft boxes, white cores, standard carton label
- 4 week lead time, after the new SKU is activated

AVAILABLE SIZES	TAPE COLOR	ROLLS PER CASE
48mm x 50m	White & Clear	36
48mm x 100m	White & Clear	36
48mm x 914m	White & Clear	6
72mm x 50m	White & Clear	24
72mm x 100m	White & Clear	24
72mm x 914m	White & Clear	4

STANDARD INKS

BLACK	WHITE	PROCESS BLUE (sky)	REFLEX BLUE (royal)	PANTONE PURPLE	PANTONE VIOLET	MAROON PMS201	NAVY PMS281	GOLD PMS132
YELLOW PMS102	ORANGE PMS021	RED PMS186	BROWN PMS469	TEAL PMS321	GREEN PMS347	LIME GREEN PMS368	COOL GRAY 5	

BRANDING & SECURITY

Security of the package in the fulfillment industry is a requirement. Confidence in the ability to ensure that the product gets to the doorstep is essential. IPG's water-activated tape, together with a host of printed pressure-sensitive tapes, make up the suite of products that are designed to offer the tamper evidence necessary in support of that security. In the case of water-activated tape, reinforced fibers come together with adhesive that double bonds and welds to the surface of the box. This further ensures that the package is extremely difficult to get into and also makes it obvious if the product has been tampered with. The fibers inside the tape and the likely destruction of the corrugate are hard to cover up.

Water-Activated Adhesive Tapes



TAMPER EVIDENT PRINTED TAPE STOCK DESIGNS

STYLE	GRADE	PRINTED MESSAGE	WIDTH x LENGTH		ROLLS PER CASE	CASES PER PALLET
			inches	feet		
K2485P001	233	Stop-Caution	70mm	450	10	63
K2525P195	260	Warning	3	600	10	60
K7000P508	240	Warning	72mm	450	10	60
K2420P001	270	Red Alert*	3.18	600	10	60
K2525P293	260	Fragile	3	600	10	60
K2034P577	140	Safe Handling	1	600	30	63
K2036P185	140	Safe Handling	1.5	600	20	63

Pressure-Sensitive Adhesive Tapes

TAMPER EVIDENT PRINTED TAPE STOCK DESIGNS

PRINT PLATE NUMBER	SIZE	PRINTED IMAGE	ADHESIVE TYPE	COLOR
TST2034	48mm		Hot Melt	White and Clear
TST3034	72mm			
TST2001	48mm		Hot Melt	White and Clear
TST3001	72mm			
TST2005	48mm		Hot Melt	White and Clear
TST3005	72mm			
TST2014	48mm		Hot Melt	White and Clear
TST3014	72mm			
TST2033	48mm		Hot Melt	White and Clear
TST3033	72mm			



CORPORATE PROFILE

Headquartered in Sarasota, Florida, IPG is a global provider of packaging and protective solutions across a diversified set of geographies and end-markets. The Company develops, manufactures, and sells a variety of solutions including paper and film-based pressure-sensitive and water-activated tapes, stretch and shrink films, protective packaging, woven and non-woven products and packaging machinery.

NORTH AMERICA

- | | | |
|----------------------|-------------------|--------------------|
| 1. Ansonia, CT | 9. Carrollton, TX | 16. Marysville, MI |
| 2. Atlanta, GA | 10. Chicago, IL | 17. Menasha, WI |
| 3. Bardstown, KY (2) | 11. Corona, CA | 18. Midland, NC |
| 5. Blythewood, SC | 12. Cornwall, ON | 19. Montreal, QC |
| 6. Brighton, CO | 13. Danville, VA | 20. Salisbury, NC |
| 7. Carbondale, IL | 14. Delta, BC | 21. Sarasota, FL |
| 8. Carlstadt, NJ | 15. Everetts, NC | 22. Schaumburg, IL |

EUROPE

- | |
|------------------------|
| 27. Flensburg, Germany |
| 28. Porto, Portugal |
| 29. Soest, Germany |
| 30. Widnes, UK |

ASIA

- | |
|--------------------------|
| 31. Chopanki, India |
| 32. Daman, India |
| 33. Dahej, India |
| 34. Jiangmen City, China |
| 35. Karoli, India |

