

# USER MANUAL HYDRO CART



# ORIGINAL INSTRUCTIONS

---

This manual was originally written in English. All translations are derived from the English version, which shall be considered the authoritative reference.

# USER NOTES

---

# TABLE OF CONTENTS

---

<b>Technical Assistance</b>	<b>4</b>
Replacement Parts	4
<b>Warranty Information</b>	<b>5</b>
<b>Warranty Information</b>	<b>6</b>
Warranty Registration	6
<b>General Information</b>	<b>7</b>
Description of the Hydro Cart	7
Definitions	7
<b>Important Safeguards</b>	<b>8</b>
Explanation of Signal Word Consequences	8
Operator Skill Level Descriptions	9
Health and Safety Precautions	9
<b>Specifications</b>	<b>10</b>
Hydro Cart Dimensions	10
Hydro Cart Components	11
Operating Conditions	12
Water Requirements	12
Technical Specifications	12
Unpacking	12
Installation	12
Charging the Battery	12
<b>Preventative Maintenance</b>	<b>14</b>
Suggested Preventative Maintenance Schedule	14
Washing the Tank	14
<b>Troubleshooting</b>	<b>14</b>
<b>Appendix</b>	<b>15</b>

# TECHNICAL ASSISTANCE

---

This is the **Hydro Cart** you ordered from **Better Packages**. If any problems occur when setting up or operating this equipment, please contact IPG Machinery Support then the authorized distributor from where you purchased this item.

Should the need to contact **IPG Machinery Support** arise, **please have the equipment model and serial number available prior to contact**. This information can be found on the nameplate of the Dispenser. A section at the bottom of this page is available to write this information down. **IPG Machinery Support** is available during normal business hours (M-F 8am-7pm) Eastern Time.

Phone: +1 813-345-3070

Email: [machsupp@itape.com](mailto:machsupp@itape.com)

## **Replacement Parts**

A breakdown of parts, including part numbers, can be provided upon request. If you know the part number that you require please contact your authorized distributor or Better Packages Customer Service 1-203-926-3700 or 1-800-237-9151 (United States only), parts can also be found directly at [www.betterpackages.com/parts](http://www.betterpackages.com/parts)

Please use this area to enter the detailed information on your Hydro Cart. This should be filled out at the time of install. This information can be found on the nameplate of the machine.

**Machine**

**Model**

**Serial**

**Distributor**

**Name**

**Phone/Email**

**Date of Purchase**

# WARRANTY INFORMATION

---

## Better Packages, Inc. Limited Warranty

Better Packages warrants each new machine and accessory to be free from defects in materials and workmanship under normal and proper use conditions. The following warranty periods from date of purchase apply:

Model	Parts	Labor
Better Pack 755e Series	2 Years	6 Months
Better Pack 555e Series	2 Years	6 Months
Better Pack 500 Series	2 Years	6 Months
Better Pack 333 Series	2 Years	6 Months
Curby Mini Taper (BP222)	1 Year	6 Months
Packer 3S	2 Years	6 Months
Tape Shooter 404	2 Years	6 Months
Auto H2O Series	1 Year	6 Months

Wearable parts such as shear blades, water brushes, motor brushes, **side guide plates and upper tape guide plates** are not covered under the warranty. The following wearable parts are warranted for 3 months from date of purchase:

1. Main Board
2. Solenoid
3. Main Motor

### Warranty Conditions and Exclusions

Machines and accessories used for any improper or unintended purpose will not be considered for warranty protection. Any modification of the machines or accessories shall make this warranty null and void. Use of replacement parts other than genuine Better Packages replacement parts shall also make this warranty null and void.

Better Packages shall have no obligation to repair or replace (1) those parts failing due to operator misuse, carelessness, or due to any accidental cause other than equipment failure, or (2) parts that fail due to:

1. Misapplication, lack of proper maintenance, abuse, improper installation, or abnormal conditions such as temperature, moisture, dirt, or corrosive matter, etc.
2. Inadequate cleaning, improper operating environment, improper utilities, or operator error.
3. Operations beyond the rated capacity of the product.
4. Alteration or servicing of the product by anyone other than an authorized representative of Better Packages.
5. Any attempt by the purchaser to repair or correct alleged defective equipment. In this event the purchaser is responsible for all expenses incurred.

**IN NO EVENT SHALL BETTER PACKAGES BE LIABLE FOR ANY INDIRECT, INCIDENTAL OR CONSEQUENTIAL DAMAGE FROM THE SALE OR USE OF THESE PRODUCTS. THIS DISCLAIMER APPLIES BOTH DURING AND AFTER THE TERM OF WARRANTY.**

**THIS WARRANTY IS EXPRESSLY IN LIEU OF ALL OTHER WARRANTIES, EXPRESS OR IMPLIED, INCLUDING THE WARRANTIES OF MERCHANTABILITY AND FITNESS FOR A PARTICULAR PURPOSE (EXCEPT AS MAY BE OTHERWISE PROVIDED BY LAW).**

**This warranty gives you specific legal rights, and you may also have other rights, which vary, from state to state.**

# WARRANTY INFORMATION

---

## Warranty Service

Better Packages will replace or repair (at the company's discretion) any defective parts within the warranty period, on a no-charge basis. The Authorized Distributor/Service Center will furnish, without charge, necessary labor to service the machine.

For service under this warranty, call or write your nearest Better Packages Distributor/Service Center or Better Packages, Inc. Ansonia, CT at 800-237-9151 (US only) or (203) 926-3700. To locate your local Authorized Distributor/Service Center, visit [www.betterpackages.com](http://www.betterpackages.com).

If customer wishes, with authorization from Better Packages or an Authorized Distributor/Service Center, a product may be shipped to Better Packages for warranty service. Any item shipped for warranty service must be shipped in the original factory carton and properly packed with the original protective packaging inserts or a secure carton that will properly protect the unit during transit. Any damage to machines or parts received improperly packed are the responsibility of the customer. All associated shipping or freight costs related to items shipped for service are the sole responsibility of the customer. Transportation charges on machines or parts returned to Better Packages for service must be prepaid by the customer. Customers will be responsible for freight expenses on parts or machines returned to them.

**Better Packages' ship-to address is:** 4 Hershey Drive, Ansonia, Connecticut 06401.

## Warranty Registration

Filling out the warranty card and returning it to us protects your warranty and allows us to keep you informed of product upgrades. Visit [www.betterpackages.com/warranty-registration](http://www.betterpackages.com/warranty-registration) to fill out the warranty card online.

# GENERAL INFORMATION

---

## Description of the Hydro Cart

The Hydro Cart is a battery operated mobile water distribution system. It is ideal for large volume users of water activated tape, and can be used to bring resupply water to pack stations alleviating the need for operators to step away from their station.

The Hydro Cart is equipped with a battery operated pump, large capacity reservoir 10 gallon (37.9 liter), and filling nozzle.



**Figure 1: Hydro Cart**

## Definitions

Common terms that will be used throughout this manual.

**WAT** – IPG Brand Water Activated Tape

**User/Operator** – The individual who has been trained on the daily use of the Machine System

**Maintenance Champion** – The individual(s) who work for the end user of the Machine System who are responsible for conducting general and preventative maintenance



# IMPORTANT SAFEGUARDS

---

## Explanation of Signal Word Consequences



**WARNING: INDICATES A POTENTIALLY HAZARDOUS SITUATION, WHICH IF NOT AVOIDED COULD RESULT IN DEATH OR SERIOUS INJURY OR PROPERTY DAMAGE**



**CAUTION: INDICATES A POTENTIALLY HAZARDOUS SITUATION, WHICH IF NOT AVOIDED COULD RESULT IN MINOR OR MODERATE INJURY OR PROPERTY DAMAGE**



### **WARNING**

1. **To reduce the risk associated with mechanical, pneumatic, and electrical hazards:**
  - Read, understand, and follow all safety and operating instructions before operating or servicing the Dispenser
  - Allow only properly trained and qualified personnel to operate and service this equipment
2. **To reduce the risk associated with pinches, entanglement, and hazardous voltage:**
  - Turn electrical supply off and disconnect before performing any adjustments, maintenance, or servicing the Dispenser
3. **To reduce the risk associated with pinches and entanglement hazards:**
  - Turn the Dispenser off when not in use
  - Never attempt to work on any part of the Dispenser, load tape, or remove jammed tape from the Dispenser while the machine is powered on
4. **To reduce the risk associated with hazardous voltage**
  - Position electrical cord away from foot traffic and vehicle traffic
  - Do not operate the Dispenser with a damaged power cord
5. **To reduce the risk associated with sharp blades hazards:**
  - Keep hand and fingers away from the tape cutoff blades, the blades are very sharp
6. **To reduce the risk associated with fire and explosion hazards:**
  - Do not operate this equipment in potentially flammable and/or explosive environments
7. **To reduce the risk associated with muscle strain:**
  - Use proper body mechanics when moving or lifting the Dispenser
8. **To reduce the risk associated with mechanical, pneumatic, and electrical hazards:**
  - Allow only properly trained and qualified personnel to operate and service this equipment
9. **Personal Protective Equipment (PPE)**
  - Follow all PPE protocols specific to the facility where the hydro cart is installed.



### **CAUTION**

1. **To reduce the risk associated with pinch hazards:**
  - Keep hands, hair, loose clothing, and jewelry away from internal components



**CAUTION: TO AVOID INJURY THE MACHINE OPERATOR SHOULD REMAIN ATTENTIVE AND SHOULD NEVER REST THEIR HANDS, ARMS, HEAD, OR ANY OTHER BODY PART ON THE MACHINE.**

This equipment is not suitable for use in locations where children are likely to be present.

IPG manufactured WAT is nonhazardous with no need for first aid measures under recommended/normal use conditions. WAT adhesive can be cleaned with soap and water.



# IMPORTANT SAFEGUARDS

## Operator Skill Level Descriptions

### Skill “A” Hydro Cart Operator

This operator is trained to use the Hydro Cart with the machine controls, to fill water bottles, and to clean and refill the Hydro Cart itself.

**Important:** The end user area supervisor must ensure that the operator has been properly trained on all machine functions before operating the machine.

### Skill “B” Mechanical Maintenance Technician

Also referred to as the Maintenance Champion, this technician, is trained to use the Hydro Cart as the Operator and to check and adjust mechanical components, to perform maintenance operations and repair the Hydro Cart. A skill “B” operator is not allowed to work on live electrical components.

### Skill “C” Factory Trained Technician

A Skill “C” technician is trained by IPG and may perform extraordinary maintenance. This includes electrical components.

Operators skill level required to perform the following tasks on the Hydro Cart

OPERATION	MACHINE CONDITION	OPERATOR SKILL LEVEL	NUMBER OF OPERATORS
Water replacement	Powered Off	A	1
Non-Electrical Part Replacement	Electrical Power Disconnected	B	1
Electrical Part Replacement	Electrical Power Disconnected	C	1

Better Packages offers a mail in factory maintenance program. Contact your Authorized IPG Representative for more information.

## Health and Safety Precautions

While the battery is a sealed unit precautions should still be taken if and when anyone comes into contact with it.



**WARNING: BATTERIES CONTAIN SULPHURIC ACID, ALWAYS WEAR APPROVED PPE WHEN HANDLING THE BATTERY.**

VRLA Battery 12 VDC 7.5Ah/20 Hour  
Battery replacement part number CRT-095



**WARNING: BATTERY POSTS, TERMINALS, AND RELATED ACCESSORIES CONTAIN LEAD AND LEAD COMPOUNDS. WASH HANDS THOROUGHLY AFTER HANDLING.**

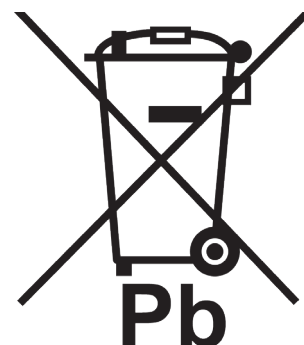
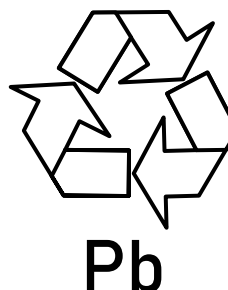

# SPECIFICATIONS

## Hydro Cart Dimensions

Hydro Cart Weight (empty):  
24 lbs (10.8kg)

Hydro Cart Weight (full 10 gallons 37.9 liters)  
107.4 lbs (48.7kg)

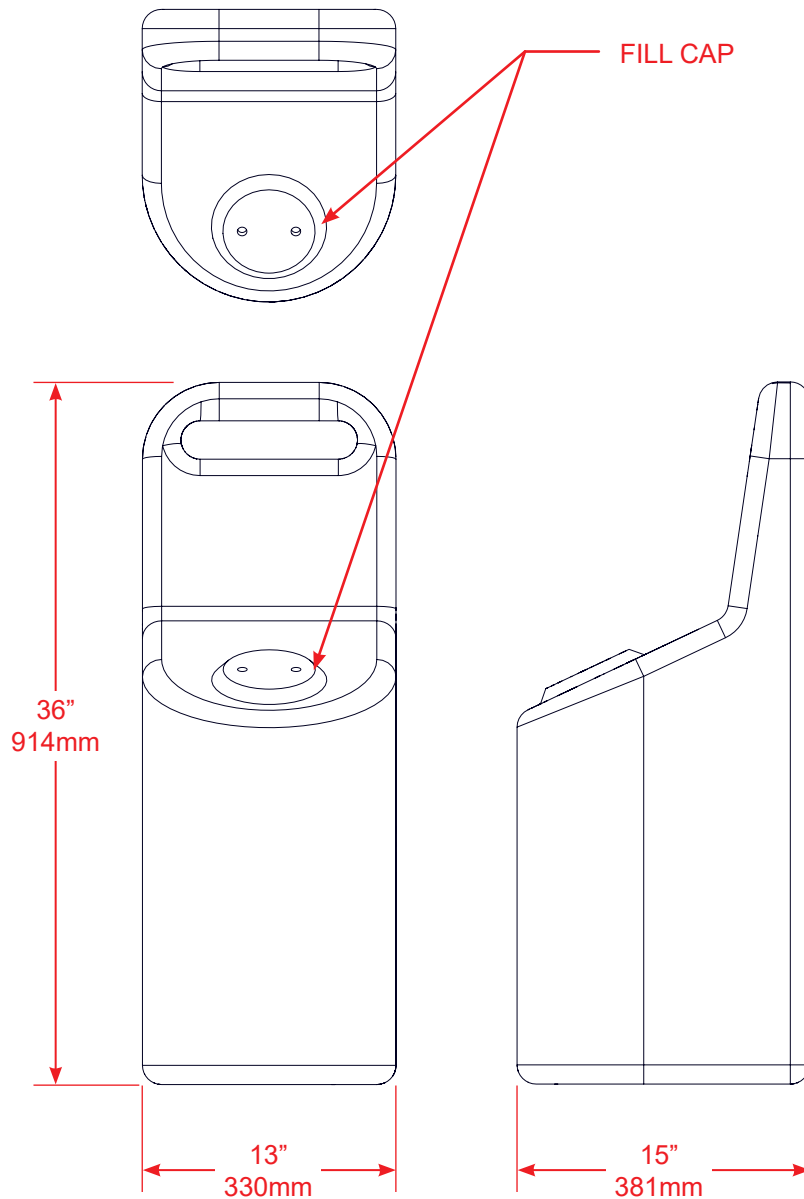

Simplified representation

**Figure 2: Hydro Cart Dimensions**

# SPECIFICATIONS

## Hydro Cart Components

Lid shown in open position.



Figure 3: Hydro Cart Components

# **SPECIFICATIONS**

---

## **Operating Conditions**

Use in a dry, relatively clean environment at 40° to 105° F (5° to 40° C). Humidity not to exceed 90% at a temperature of 68° F (20° C). The Hydro Cart will be capable of operating correctly at altitudes up to 10,000 ft. (3,000 m) above sea level.

## **Water Requirements**

Use a clean water supply. If water is mineral rich a filter system may be necessary on the main supply to extend life cycle of the Hydro Cart (this filter system is not provided by Better Packages)

## **Technical Specifications**

Flow Rate: 0.5 gpm (1.9 lpm)  
Output hose size: 3/8 in (0.95 cm)  
Output Hose Length: 12 ft (3.7 m)  
Capacity: 10 gallon (37.9 liters)  
Battery Operating Voltage: 12 VDC  
Batter Charging Voltage: 115 VAC

## **Unpacking**

After opening all the top flaps on the carton, you will find instructions for properly removing the dispenser and its included materials. It is recommended to keep all packing materials in case you need to ship the dispenser later or wish to pack and store it.

## **Installation**

The Hydro Cart is shipped with the battery disconnected. Before using the cart, connect the battery:

1. Open the back cover of the cart.
2. Locate the red and black wires with the quick disconnect connectors.
3. Plug the two connectors in together.



**WARNING: THE 12 VDC BATTERY IS A LEAD ACID BATTERY. WASH HANDS AFTER HANDLING THE BATTERY OR BATTERY COMPONENTS. IN THE EVENT OF NEEDING A REPLACEMENT BATTERY PLEASE FOLLOW ALL LOCAL AND FEDERAL GUIDELINES ON THE RECYCLING OF A LEAD ACID BATTERY.**

4. Fill the Hydro Cart with clean water.
5. Flip the power switch to the ON position.
6. Insert the nozzle into a Better Packages water bottle.
7. Squeeze the trigger to begin the flow of water.
8. When the nozzle detects a full tank it will automatically shut off the pump and stop the flow of water.
9. Adjustment may be needed to the yellow fill collar for optimal water tank filling.
10. If Step 8 is successfully completed your Hydro Cart is ready for normal use.
11. Flip the power switch to the OFF position when the Hydro Cart is not in use.

## **Charging the Battery**

1. Use only a charger provided by an Authorized IPG Representative. Other chargers may cause over charging and permanently damage the battery.
2. Connect the charger to a properly grounded 115 V Outlet.
3. Connect the other end of the charger to the Hydro Cart. The battery may require 10 hours to fully charge.



**CAUTION: DO NOT CHARGE THE HYDRO CART OUTDOORS OR IN WET AREAS. A WEAK BATTERY WILL CAUSE LOW WATER PRESSURE AND MAY NOT AUTOMATICALLY SHUT DOWN THE FLOW OF WATER WHEN DISPENSING.**

# OPERATING INSTRUCTIONS

---

Do not use the Hydro Cart when it is connected to the charger.

1. Inspect the water level prior to use.
2. If water level is below 50% add more. If not skip to Step 6.
3. Remove the black fill cap.
4. Fill with a clean source of water. Mineral heavy water or a hard water source may cause build up and may require the installation of a filter system.
5. Secure the black fill cap when the Hydro Cart is full.
6. Verify a good connection between the hose and the fill nozzle.
7. Tilt the cart back onto its wheels to easily move it around. Always push the cart in-front of you and be aware of your surroundings when moving the Hydro Cart.
8. Prior to filling a water bottle verify the Hydro Cart is securely seated on the ground and the power switch is in the ON position.
9. Remove the cap from the water bottle.
10. Place the water bottle upside-down on a stable surface. Do not fill the water bottle on or in close proximity to the dispenser or other water sensitive electronic devices.
11. Take the nozzle and insert it into the empty water bottle. The yellow stopper should rest completely against the rim of the water bottle.
12. Squeeze the handle on the nozzle to begin the flow of water.
13. The nozzle will automatically stop the flow when it detects a full bottle.
14. Move to the next station and repeat Steps 7 - 14 until complete.
15. Once watering is complete, return the Hydro Cart to its designated area and turn the power switch to the OFF position. You may need to connect it to the charger depending on the level of use.



**WARNING: NEVER OPERATE A HYDRO CART WITH A DAMAGED BATTERY. DO NOT USE A CHARGER IF THE CABLES APPEAR TO BE DAMAGED.**



**CAUTION: WHEN MOVING THE HYDRO CART BE AWARE OF YOUR SURROUNDINGS. A FULL HYDRO CART CAN WEIGHT IN EXCESS OF 100 LBS (45.4 KG).**

# PREVENTATIVE MAINTENANCE

## Suggested Preventative Maintenance Schedule



**WARNING: DISCONNECT THE BATTERY BEFORE PERFORMING ANY MAINTENANCE ON THE HYDRO CART. ONLY TRAINED SERVICE PERSONNEL ARE ALLOWED TO PERFORM ANY MAINTENANCE THAT GOES BEYOND THE MATERIAL MENTIONED ON THIS PAGE.**

### Weekly

- Wash water tank with mild soap and water. Rinse well to remove all soap residue.

### Monthly

- Verify flow through nozzle is uninterrupted. Contact IPG Support if a noticeable flow decrease is present.
- Inspect the interior of the water tank for any discoloration. This may be a sign of hard water or water with a higher level of mineral content.

### Annually

- Verify the battery holds a full charge.

## Washing the Tank

**Water Tank:** It is recommended to wash the water tank once a week in a warm soap and water solution. Rinse the tank completely before returning to normal use.

# TROUBLESHOOTING

PROBLEM	POSSIBLE CAUSES	SOLUTIONS
Water is not flowing	Battery is insufficiently charged	Connect the Hydro Cart to the charger.
	Battery is disconnected	Reconnect the battery Contact IPG Machinery Support.
	Battery is malfunctioning	If the battery does not take a charge contact IPG Machinery Support for assistance.
	Nozzle is damaged	The nozzle is designed to stop the flow of water when it detects a full bottle. This valve may be damaged. Contact IPG Machinery Support
	Nozzle is clogged	Check that the water is clean and clear. Contact IPG Machinery Support if the water is clean. Replace the nozzle if there is visible build up.
	Water Pump is malfunctioning	If all of the above is confirmed to not be the problem contact IPG Machinery Support for replacement parts and service.

If you are experiencing trouble with your Hydro Cart or it is functioning in a way that is not consistent with this manual please contact IPG Machinery Support at +1 813-345-3070 between the hours of 8am and 7pm Eastern Standard Time or via email at [machsupp@itape.com](mailto:machsupp@itape.com).

# APPENDIX

## Replacement Parts



115 VAC Charger 12 VDC Output

Item No. CRT-149



6 in Wheel Kit

Item No. INJ-677



Replacement Cap

Item No. ACC-117



Output hose with quick disconnect fitting

Item No. CRT-070



12 VDC Battery

Item No. CRT-095



12 VDC Water Pump

Item No. CRT-040



Repair Kit for Hydro Cart

Item No. ACC-066



Water Fill Nozzle

Item No. Gun-X



